

Quick Reference Instructions

BNG® SARS-CoV-2 Antigen Rapid Test

(Professional Use Only)

NOTE:

Each test is disposable. Do not try to use the test more than once.

Test Procedure

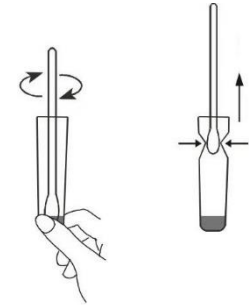

1) Take out the test cassette, swab (swab) stick and extraction solution with the from the box.

2) Wear the gloves. Use a new glove for each patient.

3) Obtain nasopharyngeal and oropharyngeal samples from the patient with a swab. (5cm depth is sufficient.)

4) Remove the blue cap of the tube containing the extraction solution. Insert the sampled swab stick.

5) Rinse the swab with the extraction solution. Let all the liquid drain by squeezing it into the wall of the tube and remove the swab stick.

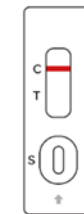
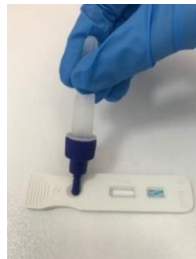

Negative

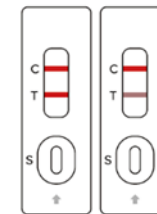

Positive

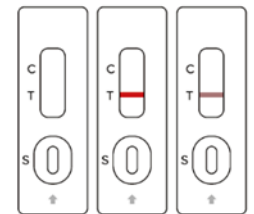

Invalid

6) Close the cap of the tube that has been mixed with the extraction solution and the swab sample.

7) Tear off the tab indicated in the green circle at the top of the blue cap.

8) Add 3 drops to the sample well (S) of the test cassette. Read the result after 15 minutes. Do not interpret the result after 30 minutes.

9) Place the test cassette, swab stick, and extraction solution in the package and throw as medical waste.

Positive: Two lines should be identified. One of the colored lines should be in the control line region (C) and the other line should be in the test region (T).

Negative: Only the control wise (C) should have a single colored line. No lines should be visible in the (T) region.

Invalid: If the control line (C) is not visible, the test is invalid.